

# BAYLAN

## WATER METERS

### TK-5C

## Multi jet Dry type Water Meter

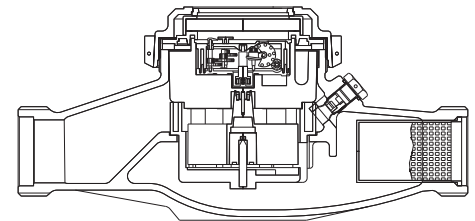

#### GENERAL

- MID Certified • Impeller chamber strainer (Optional)
- Multi jet working principle assures a long service time
- Low pressure loss, high sensitivity at initial flow
- Vacuumed mechanism • Suitable for potable water
- Electrostatic painted body made of corrosion resistant brass
- Protection against external magnetic fields
- Available for optical reading
- Pulse output and AMR reading features are optional
- 3 years of warranty • Non return valve
- Suitable for cold water up to 50°C
- Almost no maintenance • 360° rotating lid
- Stainless steel register cup is optional
- Service and spare parts available for 10 years
- IP68 Protected
- Environmental Classes

Climatic : -10°C/+55°C | Mechanic: M1/O | Elektromagnetic: E2

- $Q2 \leq Q \leq Q4$  Maximum Permissible Error
- Class 2 Water Meters;  $\% \pm 2$  (Water Temp.  $\leq 30^\circ\text{C}$ ),  $\% \pm 3$  (Water Temp.  $> 30^\circ\text{C}$ )
- Class 1 Water Meters;  $\% \pm 1$  (Water Temp.  $\leq 30^\circ\text{C}$ ),  $\% \pm 2$  (Water Temp.  $> 30^\circ\text{C}$ )
- $Q1 \leq Q < Q2$  Maximum Permissible Error
- Class 2 Water Meters;  $\% \pm 5$  | Class 1 Water Meters;  $\% \pm 3$



#### PERFORMANCE DATA

Overload Flowrate	Q4	m <sup>3</sup> /h	20
Permanent Flowrate	Q3	m <sup>3</sup> /h	16
Transitional Flowrate	Q2	m <sup>3</sup> /h	0,128
Minimum Flowrate	Q1	m <sup>3</sup> /h	0,08
Q3/Q1 (MI-001 OIML R49)			$\leq 200$
Mounting on the network			Horizontal
Maximum Registration Capacity			99999 / 99999,99 / 99999,999
Initial Flowrate	Qi	l/h	15
Maximum Working Pressure		bar	16
Maximum Working Temperature		°C	50
Pressure Loss Class		bar	0,63
Smallest Reading Resolution		m <sup>3</sup>	0,00005
Class			Class 1 / Class 2
Quantity per package			4

#### DIMENSIONS

Nominal diameter	DN	40	mm
Connecting diameter	D	G 2	B
Total overall meter height	H	148	mm
Axis height	h	42	mm
Length	L	300	mm
Width	B	135	mm
Length with connections	LB	438	mm
Unit weight		4,35	kg
Package Weight (without connect)		18,06	kg
Package Weight (with connect)		22,00	kg
Package dimensions		34x37x36	cm

#### PRESSURE LOSS CURVE

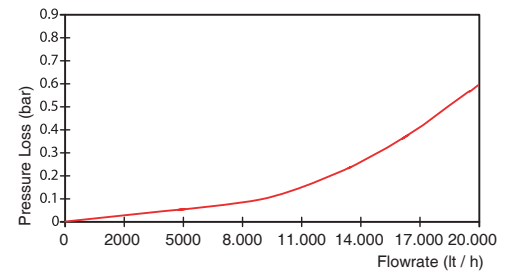

#### PERFORMANCE CURVE

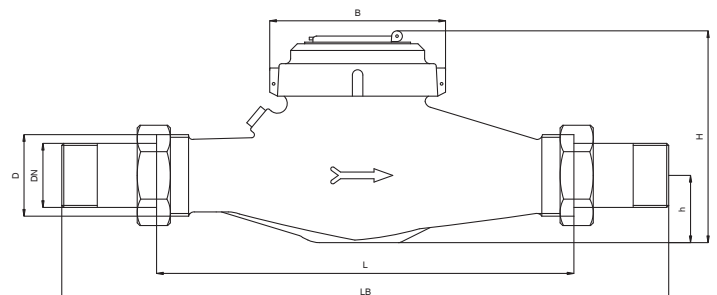
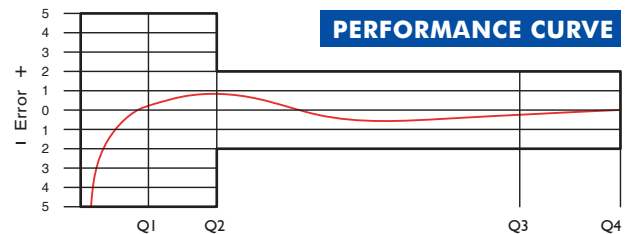

"Due to continuous development of our products, we reserve the right to modify our product design or construction without prior notice."